

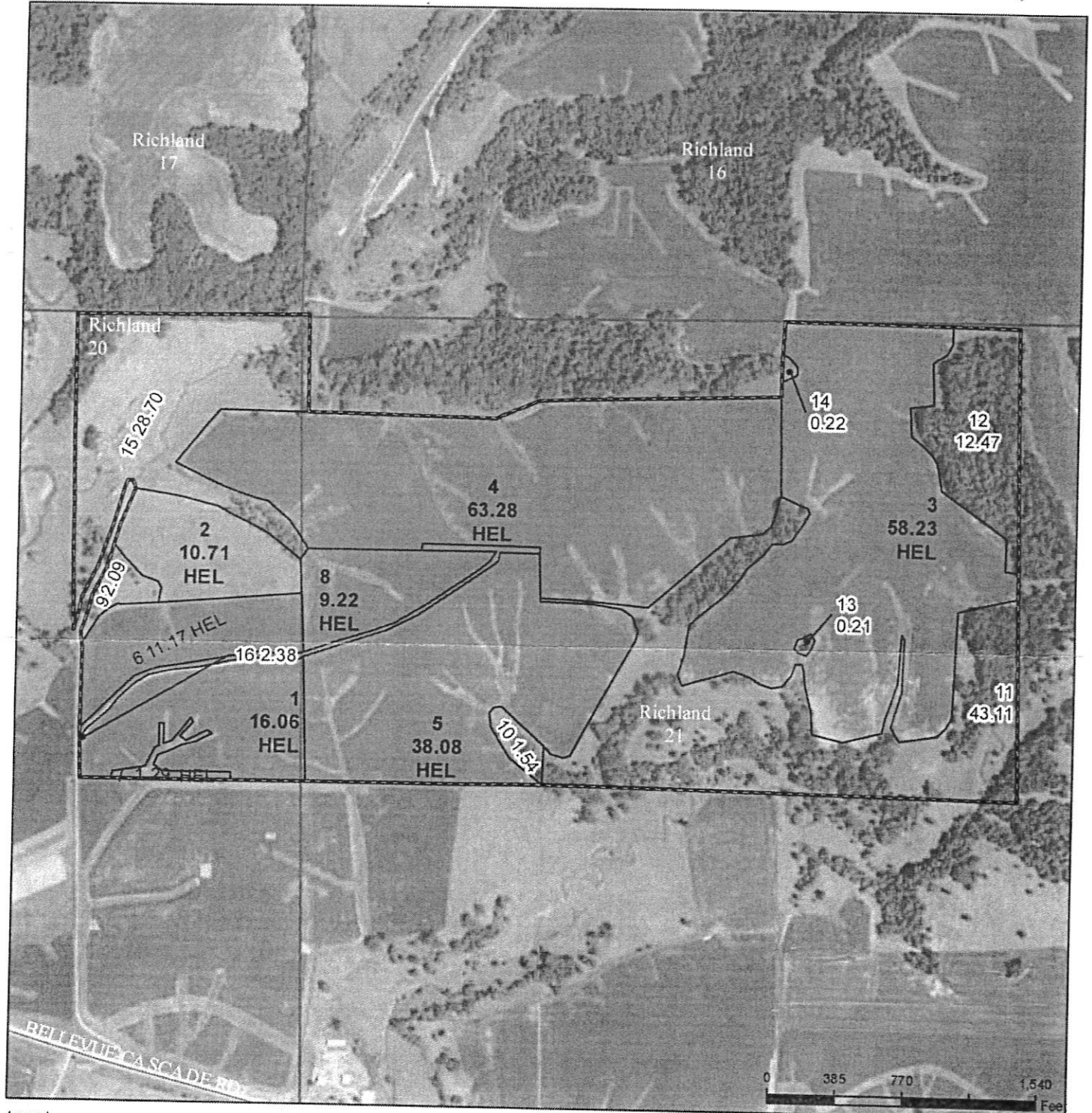

United States
Department of
Agriculture

Jackson County, Iowa



- Legend**
- Non-Cropland
 - Cropland
 - CRP
 - Tract Boundary
 - Iowa PLSS
 - Iowa Roads

Wetland Determination Identifiers

- Restricted Use
- Limited Restrictions
- Exempt from Conservation Compliance Provisions

Tract Cropland Total: 208.04 acres

2020 Program Year
Map Created June 18, 2020

Farm 6157
Tract 5226

United States Department of Agriculture (USDA) Farm Service Agency (FSA) maps are for FSA Program administration only. This map does not represent a legal survey or reflect actual ownership; rather it depicts the information provided directly from the producer and/or National Agricultural Imagery Program (NAIP) imagery. The producer accepts the data 'as is' and assumes all risks associated with its use. USDA-FSA assumes no responsibility for actual or consequential damage incurred as a result of any user's reliance on this data outside FSA Programs. Wetland identifiers do not represent the size, shape, or specific determination of the area. Refer to your original determination (CPA-026 and attached maps) for exact boundaries and determinations or contact USDA Natural Resources Conservation Service (NRCS).

USDA is an equal opportunity provider, employer, and lender.

IOWA
JACKSON



United States Department of Agriculture
Farm Service Agency

FARM : 6157

Prepared : 6/17/20 4:59 PM

Form: FSA-156EZ

Crop Year : 2020

See Page 2 for non-discriminatory Statements.

Abbreviated 156 Farm Record

Operator Name : TOM J RYAN
 Farms Associated with Operator : 19-097-233, 19-061-1812, 19-061-1820, 19-061-1878, 19-097-4539, 19-061-4623, 19-097-5692, 19-097-6157, 19-061-7207, 19-061-7210
 CRP Contract Number(s) : None
 Recon ID : 19-097-2020-43
 Transferred From : None
 ARCPLC G/M/F Eligibility : Eligible

Farm Land Data

Farmland	Cropland	DCP Cropland	WBP	WRP	CRP	GRP	Sugarcane	Farm Status	Number Of Tracts
298.76	208.04	208.04	0.00	0.00	0.00	0.00	0.00	Active	1
State Conservation	Other Conservation	Effective DCP Cropland	Double Cropped		MPL	Acre Election	EWP	DCP Ag.Rel. Activity	Broken From Native Sod
0.00	0.00	208.04	0.00		0.00		0.00	0.00	0.00

Crop Election Choice

ARC Individual	ARC County	Price Loss Coverage
None	SOYBN	OATS, CORN

DCP Crop Data

Crop Name	Base Acres	CCC-505 CRP Reduction Acres	PLC Yield	HIP
Oats	18.00	0.00	52	
Corn	92.80	0.00	150	
Soybeans	2.80	0.00	52	
TOTAL	113.60	0.00		

NOTES

Tract Number : 5226

Description : I-6&J-6 NE1/4 S20 NW1/4 S21 T86N R3E RICHLAND
 FSA Physical Location : IOWA/JACKSON
 ANSI Physical Location : IOWA/JACKSON
 BIA Unit Range Number :
 HEL Status : HEL field on tract.Conservation system being actively applied
 Wetland Status : Wetland determinations not complete
 WL Violations : None
 Owners : MARY ETTA DUNNE ESTATE
 Other Producers : RYAN BROTHERS FARMS LLC
 Recon ID : None

Tract Land Data

Farm Land	Cropland	DCP Cropland	WBP	WRP	CRP	GRP	Sugarcane
298.76	208.04	208.04	0.00	0.00	0.00	0.00	0.00
State Conservation	Other Conservation	Effective DCP Cropland	Double Cropped	MPL	EWP	DCP Ag. Rel Activity	Broken From Native Sod
0.00	0.00	208.04	0.00	0.00	0.00	0.00	0.00