

Soils Map

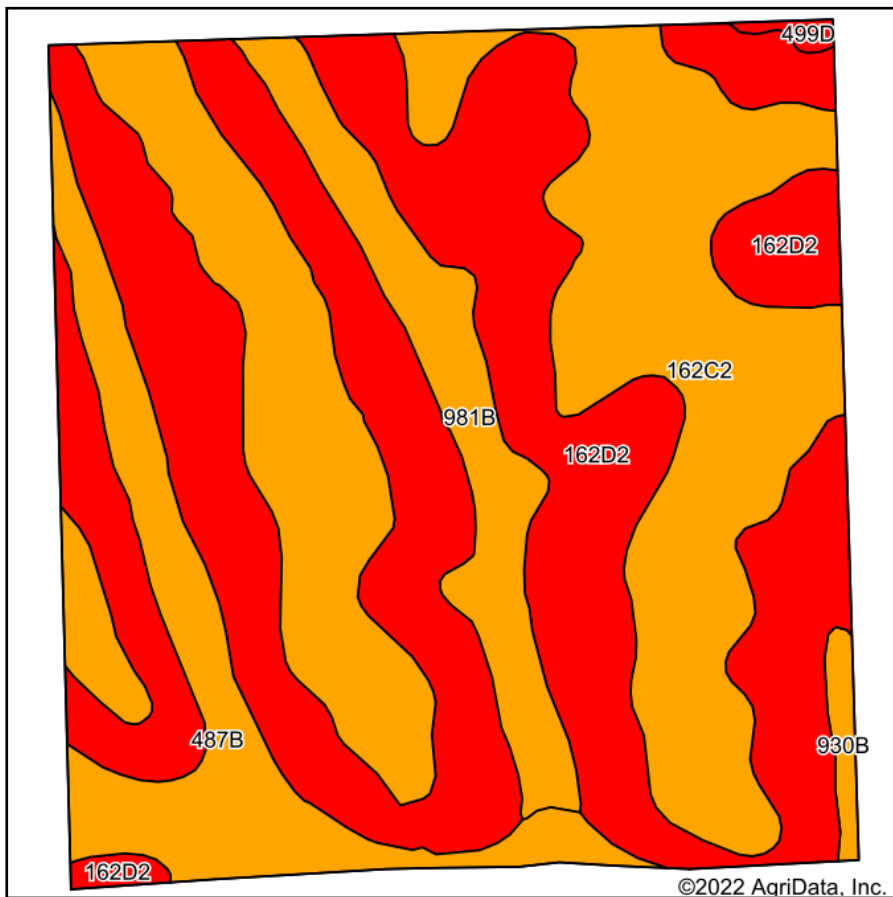

Soils data provided by USDA and NRCS.

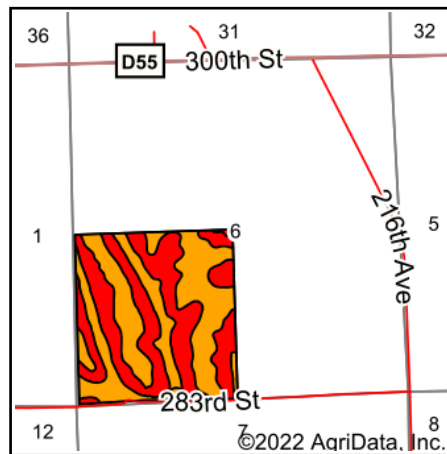

State: **Iowa**
 County: **Jackson**
 Location: **6-86N-3E**
 Township: **Richland**
 Acres: **144**
 Date: **3/10/2022**



Maps Provided By:



© AgriData, Inc. 2021

www.AgriDataInc.com

Soil Map Entire Farm



Area Symbol: IA097, Soil Area Version: 27

| Code | Soil Description | Acres | Percent of field | CSR2 Legend | Non-Irr Class *c | CSR2** | CSR | *n NCCPI Soybeans | |
|-------------------------|--|-------|------------------|-------------|------------------|-------------|-------------|-------------------|----------------|
| 162D2 | Downs silt loam, 9 to 14 percent slopes, moderately eroded | 69.38 | 48.2% | | IIIe | 54 | 63 | 69 | |
| 162C2 | Downs silt loam, 5 to 9 percent slopes, moderately eroded | 48.15 | 33.4% | | IIIe | 80 | 73 | 74 | |
| 487B | Worthen-Otter silt loams, 0 to 5 percent slopes | 14.21 | 9.9% | | IIIe | 79 | 68 | 87 | |
| 981B | Worthen silt loam, 2 to 5 percent slopes | 10.68 | 7.4% | | Ile | 94 | 90 | 83 | |
| 930B | Orion silt loam, 2 to 5 percent slopes, occasionally flooded | 1.16 | 0.8% | | IIw | 76 | 60 | 89 | |
| 499D | Nordness silt loam, 5 to 14 percent slopes | 0.42 | 0.3% | | VIIs | 6 | 5 | 36 | |
| Weighted Average | | | | | | 2.93 | 68.2 | 68.6 | *n 73.6 |

**IA has updated the CSR values for each county to CSR2.

*n: The aggregation method is "Weighted Average using all components"

*c: Using Capabilities Class Dominant Condition Aggregation Method

Soils data provided by USDA and NRCS.