

Soils Map

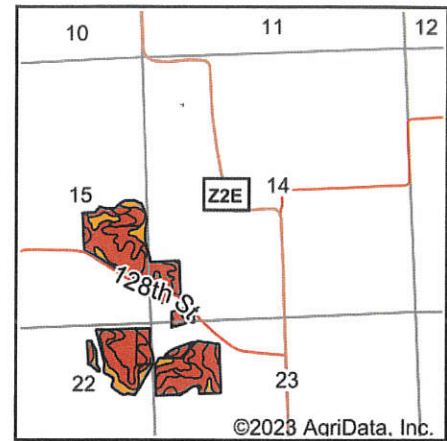

State: **Iowa**
 County: **Clinton**
 Location: **15-83N-4E**
 Township: **Waterford**
 Acres: **102.24**
 Date: **10/16/2023**

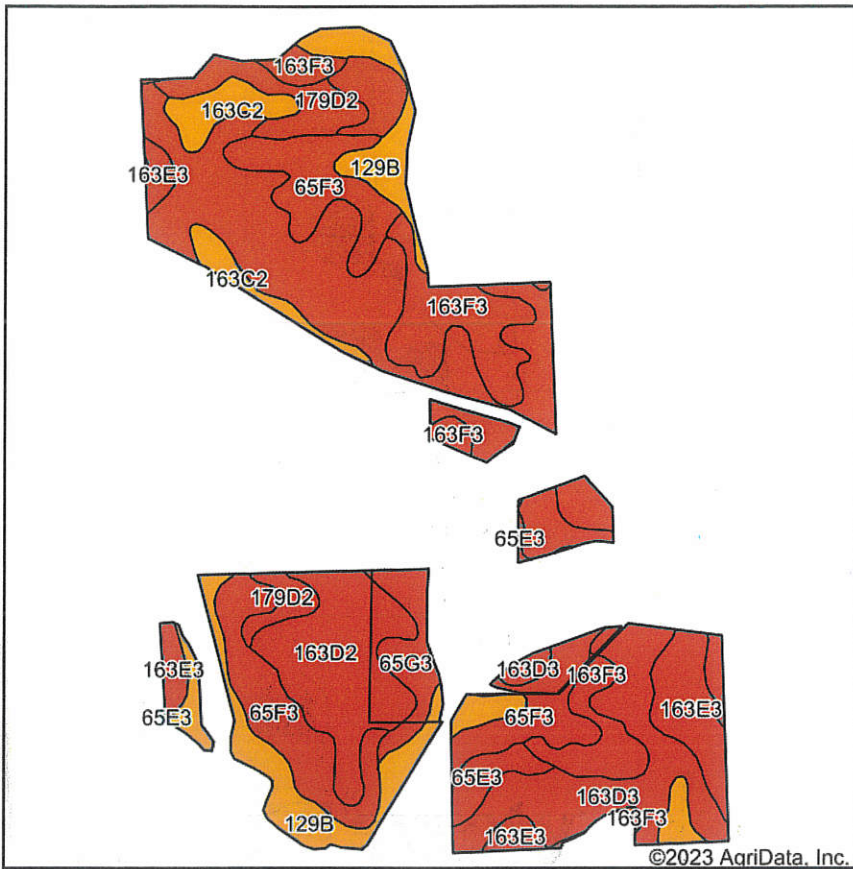

Maps Provided By:



Soils data provided by USDA and NRCS.

Area Symbol: IA045, Soil Area Version: 28

Code	Soil Description	Acres	Percent of field	CSR2 Legend	Non-Irr Class *c	CSR2**	CSR	*n NCCPI Soybeans	
163D2	Fayette silt loam, 9 to 14 percent slopes, moderately eroded	32.58	31.9%		IIIe	46	58	62	
65F3	Lindley clay loam, 18 to 25 percent slopes, severely eroded	15.82	15.5%		VIIe	5	5	32	
163D3	Fayette silty clay loam, 9 to 14 percent slopes, severely eroded	12.44	12.2%		IVe	40	55	53	
129B	Arenzville-Chaseburg complex, 1 to 5 percent slopes	10.54	10.3%		IIw	73		83	
163F3	Fayette silty clay loam, 18 to 25 percent slopes, severely eroded	10.54	10.3%		VIIe	12	25	36	
163E3	Fayette silty clay loam, 14 to 18 percent slopes, severely eroded	6.30	6.2%		VIe	29	45	50	
163C2	Fayette silt loam, 5 to 9 percent slopes, moderately eroded	4.73	4.6%		IIIe	72	68	66	
179D2	Gara loam, 9 to 14 percent slopes, moderately eroded	4.55	4.5%		IVe	45	43	52	
65G3	Lindley clay loam, 25 to 40 percent slopes, severely eroded	2.96	2.9%		VIIe	5	5	6	
65E3	Lindley clay loam, 14 to 18 percent slopes, severely eroded	1.78	1.7%		VIIe	21	25	43	
Weighted Average						4.46	36.7	*-	*n 52.8

**IA has updated the CSR values for each county to CSR2.

*- CSR weighted average cannot be calculated on the current soils data, use prior data version for csr values.

*n: The aggregation method is "Weighted Average using all components"

*c: Using Capabilities Class Dominant Condition Aggregation Method

Soils data provided by USDA and NRCS.