

Soils Map

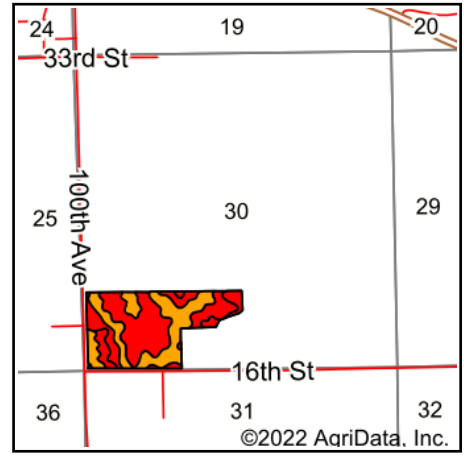

State: **Iowa**
 County: **Jackson**
 Location: **30-84N-2E**
 Township: **South Fork**
 Acres: **60**
 Date: **12/6/2022**

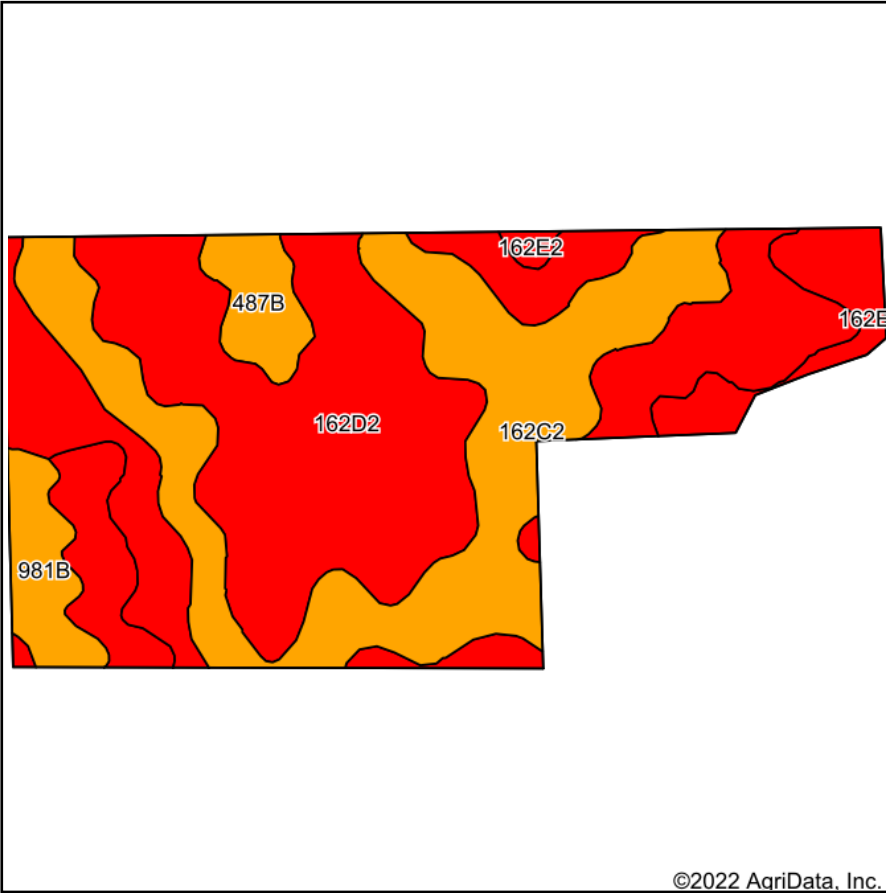

Maps Provided By:



Soils data provided by USDA and NRCS.

©2022 AgriData, Inc.

© AgriData, Inc. 2021

www.AgriDataInc.com

Area Symbol: IA097, Soil Area Version: 28

Code	Soil Description	Acres	Percent of field	CSR2 Legend	Non-Irr Class *c	CSR2**	CSR	*n NCCPI Soybeans	
162D2	Downs silt loam, 9 to 14 percent slopes, moderately eroded	31.33	52.2%		IIIe	54	63	67	
162C2	Downs silt loam, 5 to 9 percent slopes, moderately eroded	17.76	29.6%		IIIe	80	73	72	
162E2	Downs silt loam, 14 to 18 percent slopes, moderately eroded	6.06	10.1%		IVe	42	53	62	
981B	Worthen silt loam, 2 to 5 percent slopes	2.60	4.3%		Ile	94	90	83	
487B	Worthen-Otter silt loams, 0 to 5 percent slopes	2.25	3.8%		IIIe	79	68	87	
Weighted Average						3.06	63.2	66.3	*n 69.4

**IA has updated the CSR values for each county to CSR2.

*n: The aggregation method is "Weighted Average using all components"

*c: Using Capabilities Class Dominant Condition Aggregation Method

Soils data provided by USDA and NRCS.